

# 29

MODEL

## GAUGELESS

MODEL SHOWN:  
29-15C-300

### DESCRIPTION

The Model 29 gaugeless regulator is specifically designed for use in installations where rough handling of gas apparatus is commonplace. The color coded cylinder contents indicator and the delivery pressure calibration on the bonnet are easy to read.

### DETAILS

**Capacity:** Heavy duty  
**C<sub>v</sub>:** 0.17  
**Gauges:** N/A  
**Pressure Regulation:** 0.2 PSIG/100 PSIG

**Seat:** One-piece encapsulated seat design with internal filter and PTFE Teflon® seat  
**Certifications:** UL® listed/CGA E-4  
**Weight:** 2.7 lbs./1.2247 kg.



Additional Technical Information: PG. 165

PART #	Model #	GAS	MAX. INLET PSIG	DELIVERY PRESSURE RANGE PSIG	DELIVERY PRESSURE GAUGE PSIG	SUPPLY PRESSURE GAUGE PSIG	INLET CONNECTION	OUTLET CONNECTION
3600260	29-15C-510	ACETYLENE	500	0 - 15	-	-	CGA 510	3/16" - 18 LH
3600250	29-15C-300	ACETYLENE	500	0 - 15	-	-	CGA 300	3/16" - 18 LH
3600320	29-50C-510P	LPG*	500	0 - 50	-	-	CGA 510P	3/16" - 18 LH
3600340	29-100C-540	OXYGEN	3000	0 - 100	-	-	CGA 540	3/16" - 18 RH
3600200	29-100C-540SG	OXYGEN	3000	0 - 100	-	-	CGA 540SG	3/16" - 18 RH
3600345	29-100C-580	Ar, He, N <sub>2</sub>	3000	0 - 100	-	-	CGA 580	3/16" - 18 RH

\*Regulator designed specifically for propane service can be used with any of the other welding grade liquid petroleum gases. NOT FOR USE WITH ACETYLENE.

# 2500

MODEL

## PREMIUM STAINLESS STEEL DIAPHRAGM

MODEL SHOWN:  
2500-125-540

### DESCRIPTION

The Model 2500 is a Harris premium single-stage offering. It features a stainless steel diaphragm, a tamper-proof, self-reseating internal HP safety valve and a one-piece encapsulated seat.

### DETAILS

**Capacity:** Heavy duty  
**C<sub>v</sub>:** 0.17  
**Gauges:** 2.5" brass  
**Pressure Regulation:** 0.3 PSIG/100 PSIG

**Seat:** One-piece encapsulated seat design with internal filter and PTFE Teflon® seat  
**Certifications:** UL® listed/CGA E-4  
**Where Used:** V-Series® Pipeliner® kits  
**Weight:** 4.6 lbs./2.0865 kg.



Additional Technical Information: PG. 166

PART #	Model #	GAS	MAX. INLET PSIG	DELIVERY PRESSURE RANGE PSIG	DELIVERY PRESSURE GAUGE PSIG	SUPPLY PRESSURE GAUGE PSIG	INLET CONNECTION	OUTLET CONNECTION
3002508	2500-15-300	ACETYLENE	500	0 - 15	30RZ	400	CGA 300	3/16" - 18 LH
3002500	2500-15-510	ACETYLENE	500	0 - 15	30RZ	400	CGA 510	3/16" - 18 LH
3002502	2500-50-510P	LPG*	500	0 - 50	100	400	CGA 510P	3/16" - 18 LH
3002504	2500-125-540	OXYGEN	3000	0 - 125	200	4000	CGA 540	3/16" - 18 RH
3002511	2500-50-540	OXYGEN	3000	0 - 50	100	4000	CGA 540	3/16" - 18 RH
3002519	2500-125-580	Ar, He, N <sub>2</sub>	3000	0 - 125	200	4000	CGA 580	3/16" - 18 RH

\*Regulators designed specifically for LPG service can be used with any of the other welding grade liquid petroleum gases. NOT FOR USE WITH ACETYLENE.

# MODELS 425, 29 & 25GX

PERFORMANCE CHART  
ALL FLOWS BASED ON AIR @ 70°F

## MODEL 425

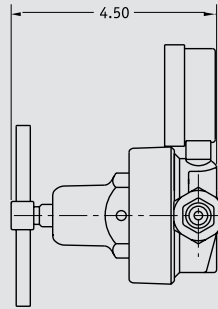
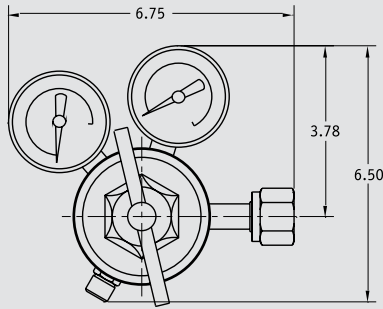

### DETAILS

**Regulator Weight:** 3.7 lbs.  
**Pressure Rise:** 0.2 PSIG per 100 PSIG  
**C<sub>v</sub>:** 0.17

## MODEL 29

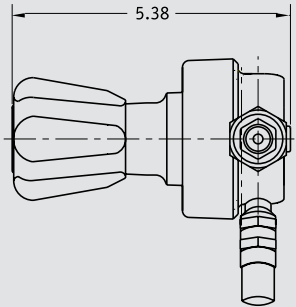
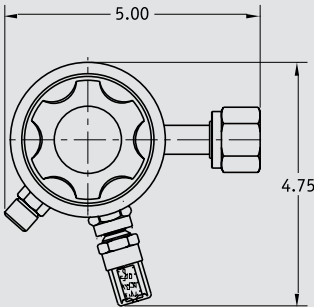

### DETAILS

**Regulator Weight:** 2.7 lbs.  
**Pressure Rise:** 0.2 PSIG per 100 PSIG  
**C<sub>v</sub>:** 0.17

## MODEL 25GX

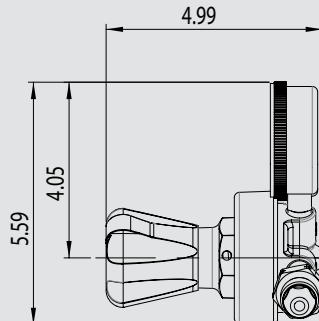
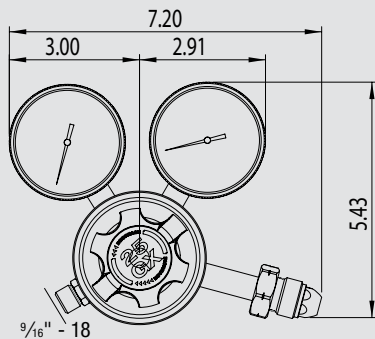

### DETAILS

**Regulator Weight:** 2.9 lbs.  
**Pressure Rise:** 0.2 PSIG per 100 PSIG  
**C<sub>v</sub>:** 0.17

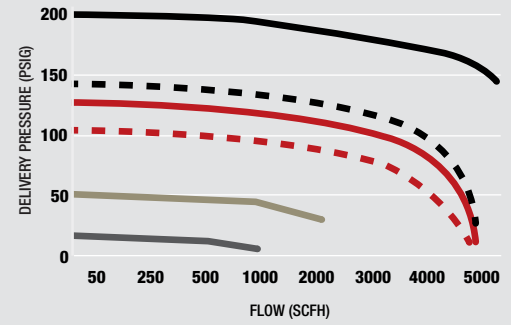

#### MODEL 425, 29 AND 25GX - 2000 PSIG INLET

- 425, 25GX-200 @ 2000 PSIG inlet
- - 25GX-145 @ 2000 PSIG inlet
- 425-125 @ 2000 PSIG inlet
- - 29-100 @ 2000 PSIG inlet
- 425, 29, 25GX-50 @ 2000 PSIG inlet
- 425, 29, 25GX-15 @ 2000 PSIG inlet

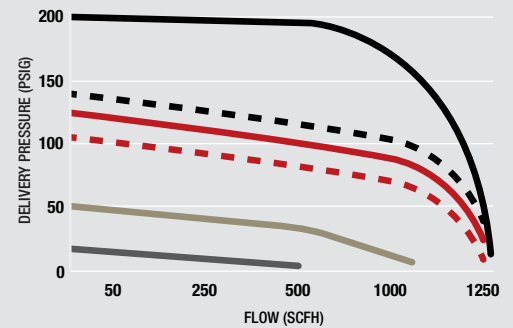

#### MODEL 425, 29 AND 25GX - 200 PSIG INLET

- 425, 25GX-200 @ 200 PSIG inlet
- - 25GX-145 @ 200 PSIG inlet
- 425-125 @ 200 PSIG inlet
- - 29-100 @ 200 PSIG inlet
- 425, 29, 25GX-50 @ 200 PSIG inlet
- 425, 29, 25GX-15 @ 200 PSIG inlet