

601

MODEL



ECONOMICAL

MODEL SHOWN:
601-15-520 A

DESCRIPTION

This single-stage regulator is designed to be compact and economical, but with features typically available in more expensive regulators. It is used where weight, cost and size are factors.

DETAILS

Capacity: Light duty

C_v: 0.08

Gauges: 50mm ABS plastic

Pressure Regulation:
0.4 PSIG/100 PSIG

Seat: One-piece encapsulated seat design with internal filter and PTFE Teflon® seat

Certifications: UL® listed/CGA E-4

Featured In: Expert® series kits, air fuel equipment kits, Port-A-Torch®

Weight: 1.39 lbs. /0.63 kg.



Additional Technical Information: PG. 163

PART #	MODEL #	GAS	MAX. INLET PSIG	DELIVERY PRESSURE RANGE PSIG	DELIVERY PRESSURE GAUGE PSIG	SUPPLY PRESSURE GAUGE PSIG	INLET CONNECTION	OUTLET CONNECTION
3000295	601-15-200	ACETYLENE	400	0 - 15	30RZ	400	CGA 200	"B" 1/8" - 18 LH
3000407	601-15-200 A	ACETYLENE	400	0 - 15	30RZ	400	CGA 200	"A" 3/8" - 24 LH
3000408	601-15-520 A	ACETYLENE	400	0 - 15	30RZ	400	CGA 520	"A" 3/8" - 24 LH
3000411	601-15-520	ACETYLENE	400	0 - 15	30RZ	400	CGA 520	"B" 1/8" - 18 LH
3000331	601-15-510	ACETYLENE	400	0 - 15	30RZ	400	CGA 510	"B" 1/8" - 18 LH
3000322	601-15-300	ACETYLENE	400	0 - 15	30RZ	400	CGA 300	"B" 1/8" - 18 LH
3000409	601-50-510P	LPG*	400	0 - 50	60	400	CGA 510P	"B" 1/8" - 18 LH
3002317	601-50-600	LPG*	400	0 - 50	60	400	CGA 600	"B" 1/8" - 18 LH
3002318	601-50-600A	LPG*	400	0 - 50	60	400	CGA 600	"A" 3/8" - 24 LH
3000296	601-80-540	OXYGEN	3000	0 - 80	100	4000	CGA 540	"B" 1/8" - 18 RH
3000412	601-80-540 A	OXYGEN	3000	0 - 80	100	4000	CGA 540	"A" 3/8" - 24 RH

*Regulator designed specifically for propane service can be used with any of the other welding grade liquid petroleum gases. NOT FOR USE WITH ACETYLENE.

301

MODEL



COMPACT

MODEL SHOWN:
301-100-540

DESCRIPTION

This single-stage regulator is designed to be compact, light weight and rugged. It provides accurate pressure regulation to 100 PSIG.

DETAILS

Capacity: Light to medium duty

C_v: 0.08

Gauges: 2" Steel dual scale

Pressure Regulation:
0.4 PSIG/100 PSIG

Seat: One-piece encapsulated seat design with internal filter and PTFE Teflon® seat

Certifications:
UL® listed/CGA E-4

Weight: 2.2 lbs./0.99 kg.



Additional Technical Information: PG. 163

PART #	MODEL #	GAS	MAX. INLET PSIG	DELIVERY PRESSURE RANGE PSIG	DELIVERY PRESSURE GAUGE PSIG	SUPPLY PRESSURE GAUGE PSIG	INLET CONNECTION	OUTLET CONNECTION
3000165	301-15-200MC	ACETYLENE	400	0 - 15	30RZ	400	CGA 200 MC	1/8" - 18 LH
3000160	301-15-300	ACETYLENE	400	0 - 15	30RZ	400	CGA 300	1/8" - 18 LH
3000161	301-15-510	ACETYLENE	400	0 - 15	30RZ	400	CGA 510	1/8" - 18 LH
3000166	301-15-520B	ACETYLENE	400	0 - 15	30RZ	400	CGA 520B	1/8" - 18 LH
3000162	301-100-540	OXYGEN	3000	0 - 100	150	4000	CGA 540	1/8" - 18 RH
3000187	301-100-580	Ar, He, N ₂	3000	0 - 100	150	4000	CGA 580	1/8" - 18 RH
3000192	301-100-320	CO ₂	3000	0 - 100	150	4000	CGA 320	1/8" - 18 RH

MODELS 601 & 301

MODEL 601

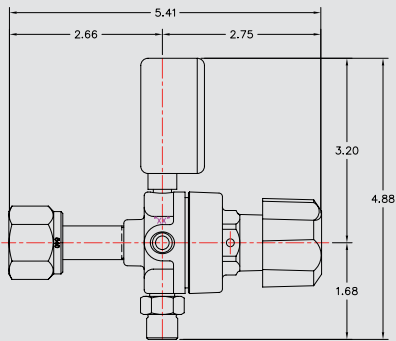

DETAILS

Regulator Weight: 1.39 lbs./0.63 kg.
Pressure Rise: 0.43 PSIG per 100 PSIG
C_v: 0.08

MODEL 301

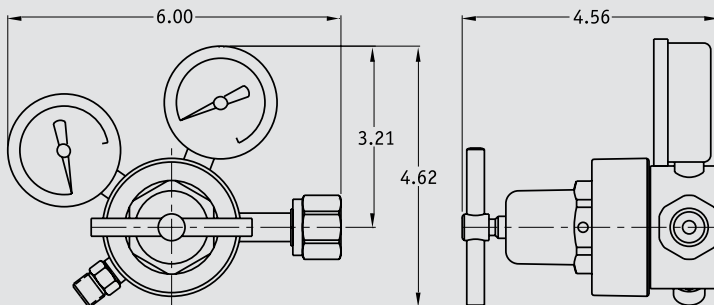

DETAILS

Regulator Weight: 2.2 lbs./0.99 kg
Pressure Rise: 0.4 PSIG per 100 PSIG
C_v: 0.08

PERFORMANCE CHART ALL FLOWS BASED ON AIR @ 70°F

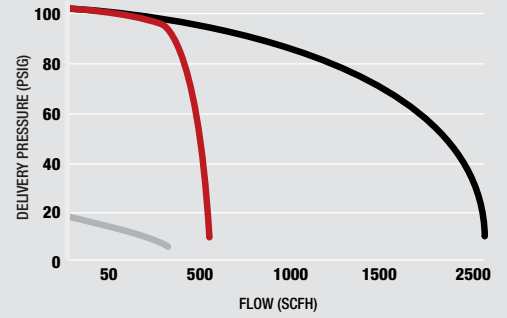

MODEL 601 SINGLE-STAGE REGULATOR

- 601-100 @ 2000 PSIG inlet
- 601-100 @ 200 PSIG inlet
- 601-15 @ 200 PSIG inlet

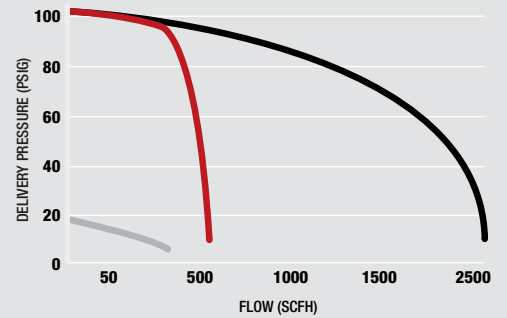

MODEL 301 SINGLE-STAGE REGULATOR

- 301-100 @ 2000 PSIG inlet
- 301-100 @ 200 PSIG inlet
- 301-15 @ 200 PSIG inlet